

Clutch Assembly Removal, Inspection, and Installation

Removal (See Fig. 1)

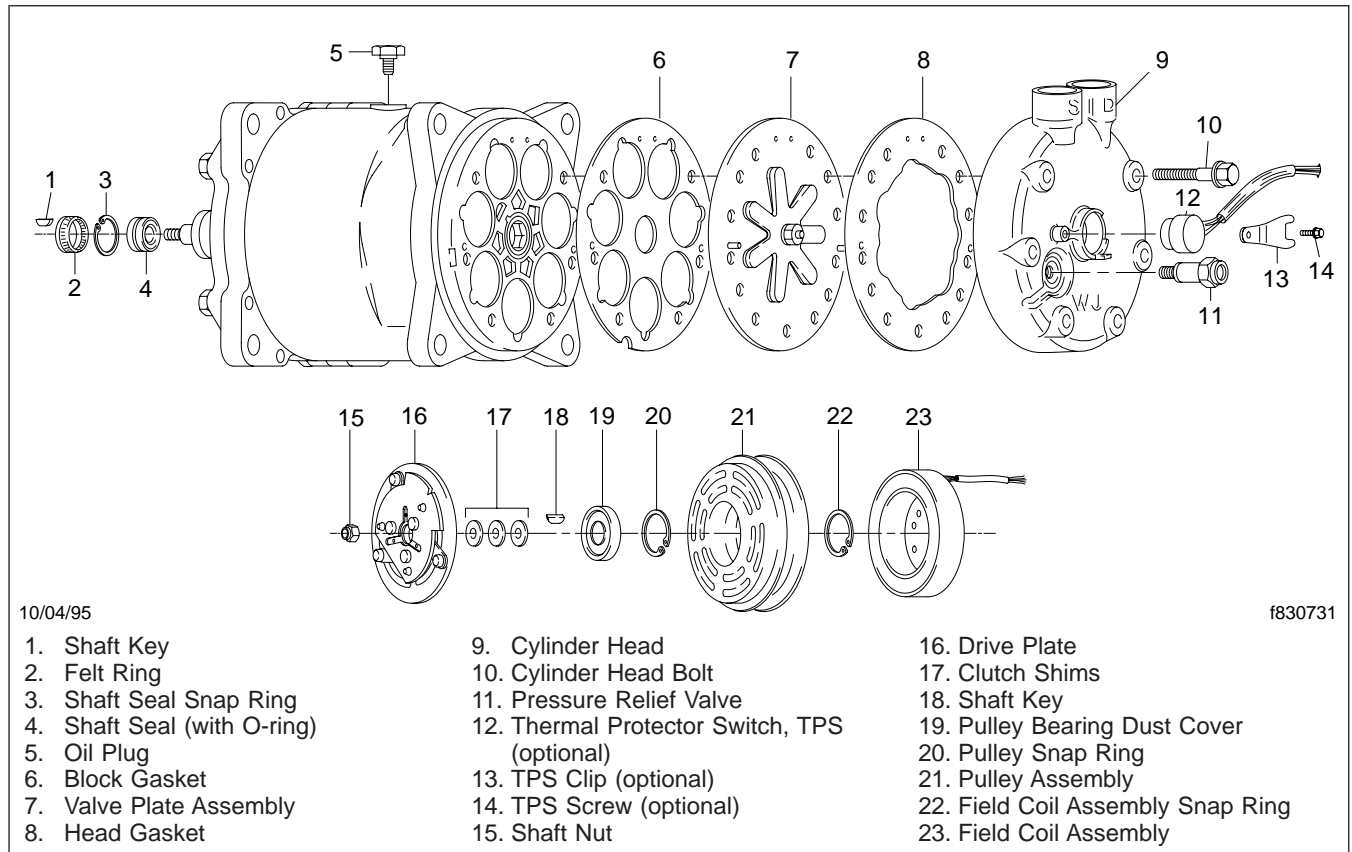

Fig. 1, Refrigerant Compressor (exploded view)

1. Remove the compressor from the vehicle. For instructions, see [Subject 120](#).
2. Remove the six bolts that attach the drive plate cover and remove the cover.
3. Insert the pins of the drive plate spanner into the threaded holes of the drive plate. Hold the drive plate securely while removing the retaining nut. See [Fig. 2](#).
4. Using the drive-plate puller, thread the three puller bolts into the drive plate. Turn the center screw clockwise to loosen and remove the drive plate. See [Fig. 3](#).
5. Remove the pulley bearing dust cover (if equipped), the shaft key, and the clutch shims. Use a slotted screwdriver and hammer to tap the shaft key loose. See [Fig. 4](#).
6. Using external snap-ring pliers, remove the pulley assembly snap ring.
7. Remove the pulley assembly.
 - 7.1 Insert the lip of the pulley puller jaws into the snap ring groove. See [Fig. 5](#).
 - 7.2 Place the puller shaft protector over the exposed shaft.
 - 7.3 Align the thumb screws with the puller jaws. Tighten the screws finger tight.
 - 7.4 Using a socket wrench, turn the puller center bolt clockwise and remove the pulley.
8. Remove the coil assembly.
 - 8.1 Remove the coil's lead wire from the wire holder on the compressor.

Clutch Assembly Removal, Inspection, and Installation

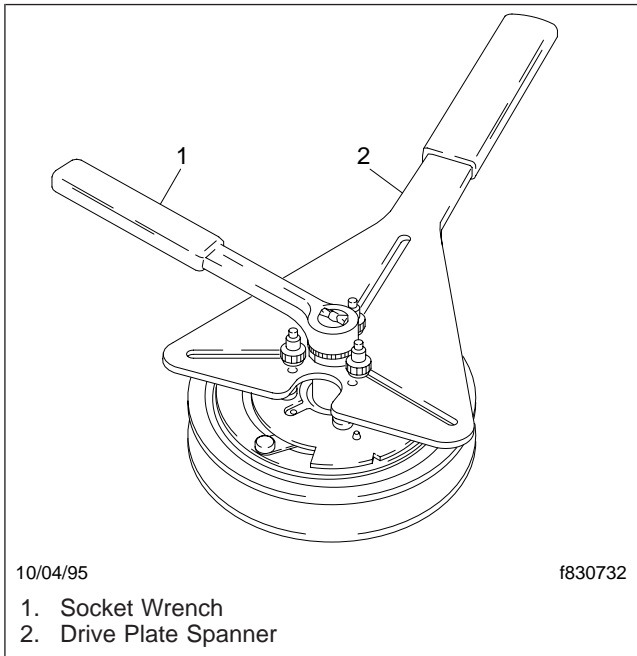

Fig. 2, Remove the Retaining Nut

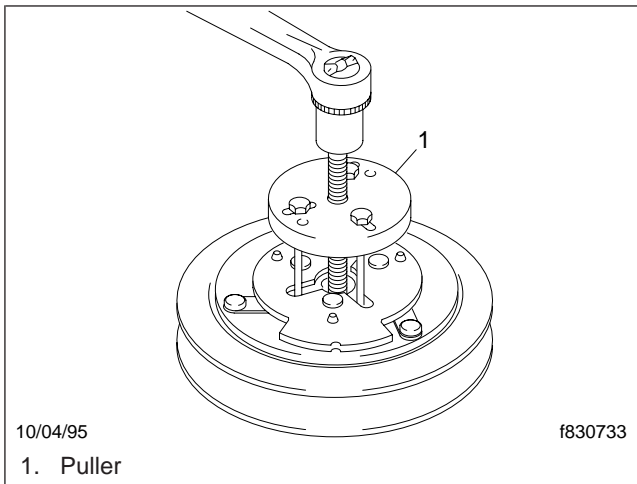

Fig. 3, Remove the Drive Plate

- 8.2 Disconnect the wiring harness.
- 8.3 Remove the snap ring ([Fig. 6](#)); then, remove the coil assembly.

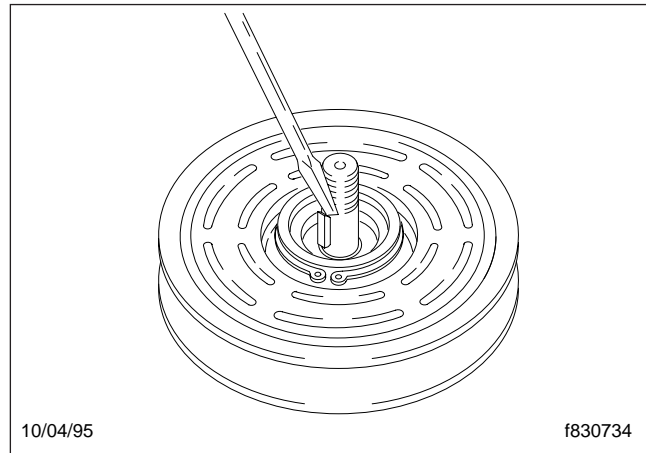

Fig. 4, Remove the Shaft Key

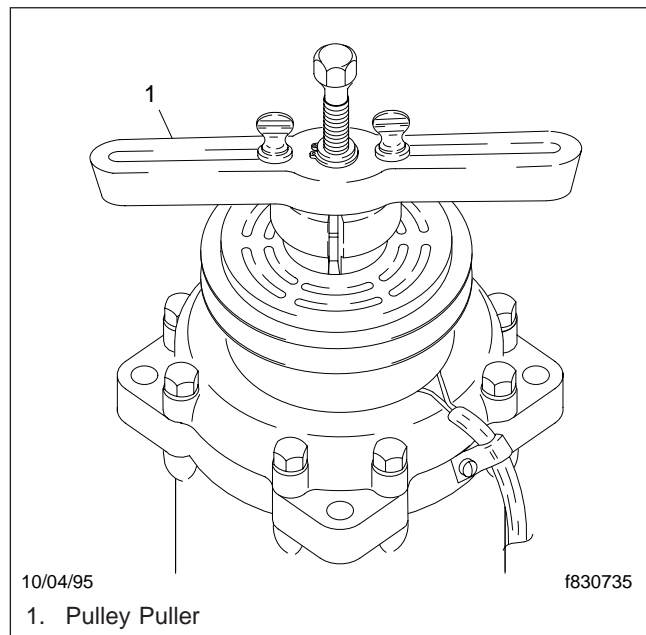

Fig. 5, Position the Pulley Puller Jaws

Inspection

1. Inspect the drive plate. If the frictional surface shows signs of damage due to too much heat, replace the drive plate and pulley assembly.
2. Check the appearance of the pulley assembly. If the friction surface of the pulley shows signs of too much grooving due to slippage, replace both the pulley and drive plate. Clean the friction surfaces of the pulley assembly before installing it.

Clutch Assembly Removal, Inspection, and Installation

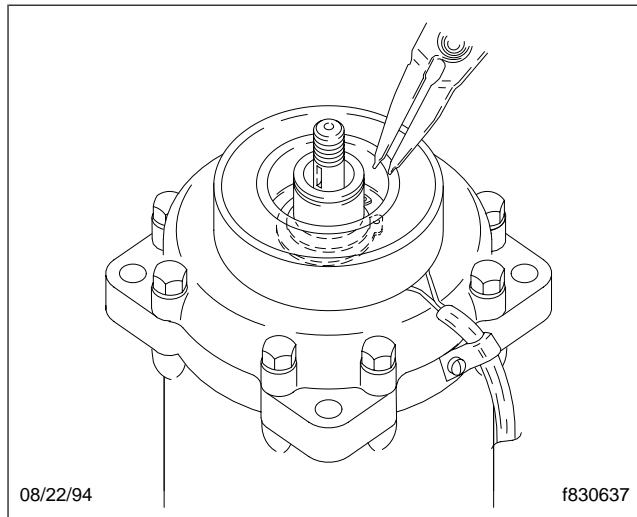

Fig. 6, Remove the Snap Ring

3. Check the coil for a loose connector and for cracked insulation. Replace it if necessary.

Installation

NOTE: When supporting the compressor in a vise, clamp only on the mounting ears, never on the body of the compressor.

1. Install the coil assembly.
 - 1.1 Position the coil assembly on the compressor.
 - 1.2 Install the snap ring.
 - 1.3 Attach the coil's lead wire to the wire holder on the compressor.
 - 1.4 Connect the wiring harness.
2. Install the pulley assembly.
 - 2.1 Position the pulley over the boss of the front housing.
 - 2.2 Place the pulley installer ring into the bearing bore. Make sure that the edge rests only on the inner race of the bearing, not on the seal, pulley, or outer race of the bearing.
 - 2.3 Place the driver into the ring. Using a hammer or arbor press, drive the pulley down against the front housing step. See [Fig. 7](#).

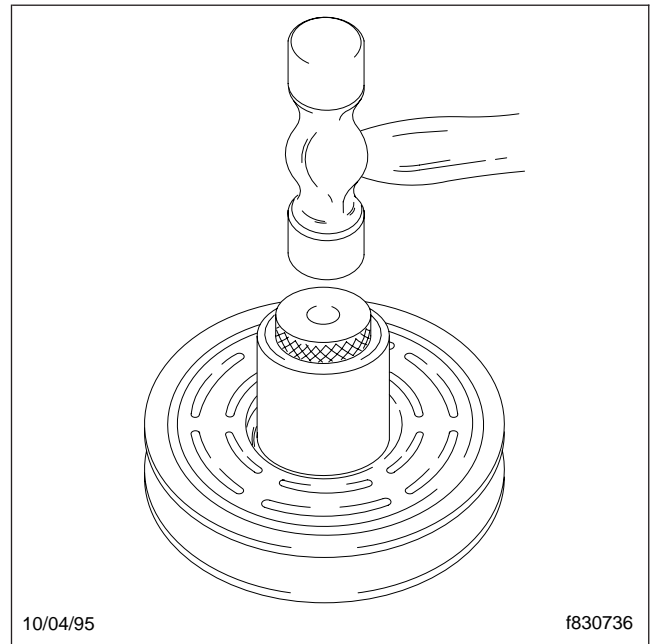

Fig. 7, Drive the Pulley Down Against the Front Housing Step.

- 2.4 Using internal snap ring pliers, install the pulley bearing snap ring.
- 2.5 Using external snap ring pliers, install the pulley snap ring. If a bevel is present on the snap ring, make sure that it is facing up (away from the body of the compressor).
- 2.6 Install the pulley bearing dust cover by gently tapping it into place.
3. Install the drive plate assembly.
 - 3.1 Using pliers, install the shaft key. See [Fig. 8](#).
 - 3.2 Install the shims.
 - 3.3 Align the keyway in the drive plate assembly with the shaft key. Using a driver, and a hammer or an arbor press, drive the assembly down over the shaft until it bottoms on the shims. See [Fig. 9](#).
 - 3.4 Install the retaining nut. Tighten the nut to the torque in [Specifications 400](#).
4. Using a feeler gauge, check that the clutch clearance is 0.02 to 0.03 inch (0.4 to 0.8 mm). See [Fig. 10](#). Adjust the clearance by gently tapping

Clutch Assembly Removal, Inspection, and Installation

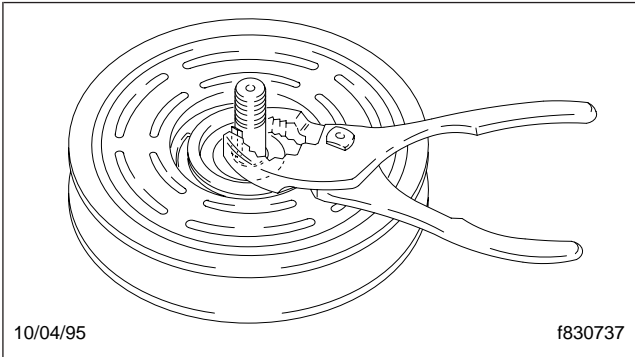

Fig. 8, Install the Shaft Key

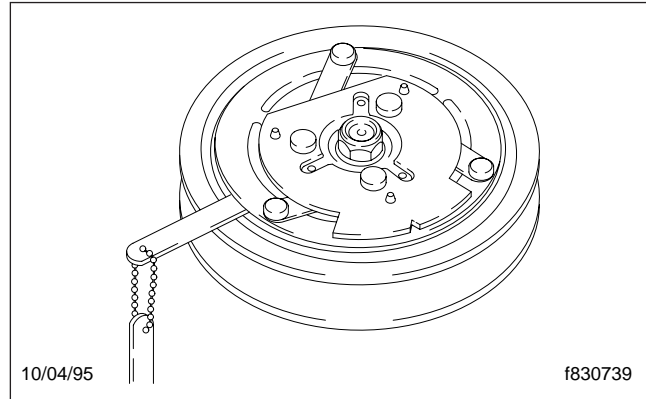

Fig. 10, Check the Clutch Clearance

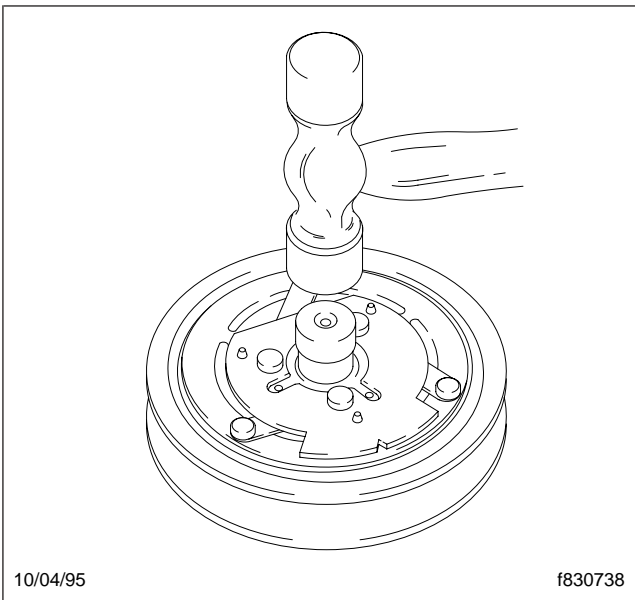

Fig. 9, Install the Drive Plate Assembly

down on the front plate at the high spots, or gently prying up at the low spots.

5. Install the drive plate dust cover. Tighten the bolts to the torque in **Specifications 400**.
6. Install the compressor on the vehicle. For instructions, see **Subject 120**.